

DOLPHIN DECK
Staterooms 1800–1964
90 ft. from bow to
Staterooms 1800 & 1801.

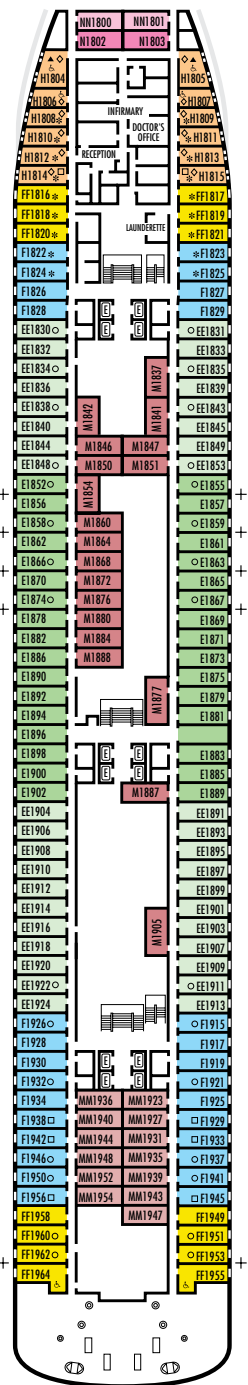

52 ft. to stern from
Staterooms 1955 & 1964.

MAIN DECK
Staterooms 2500–2715
103 ft. from bow to
Staterooms 2500 & 2501.

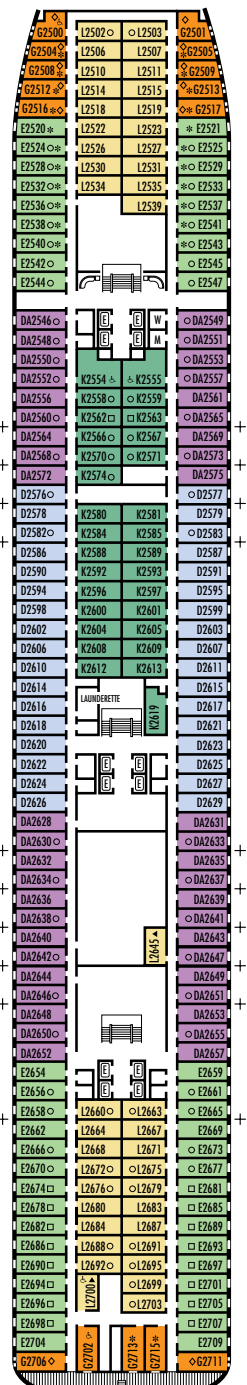

16 ft. to stern from
Staterooms 2702, 2706, 2711,
2713 & 2715.

LOWER PROMENADE DECK
Staterooms 3300–3433
118 ft. from bow to
Staterooms 3300 & 3301.

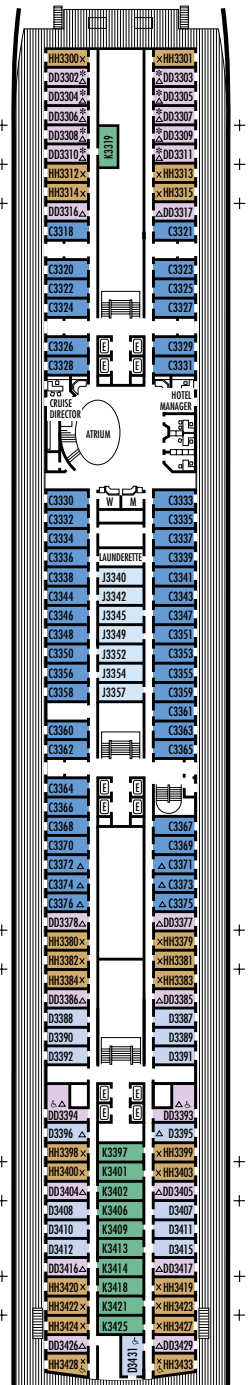

21 ft. to stern from
Staterooms 3428 & 3433.

PROMENADE DECK

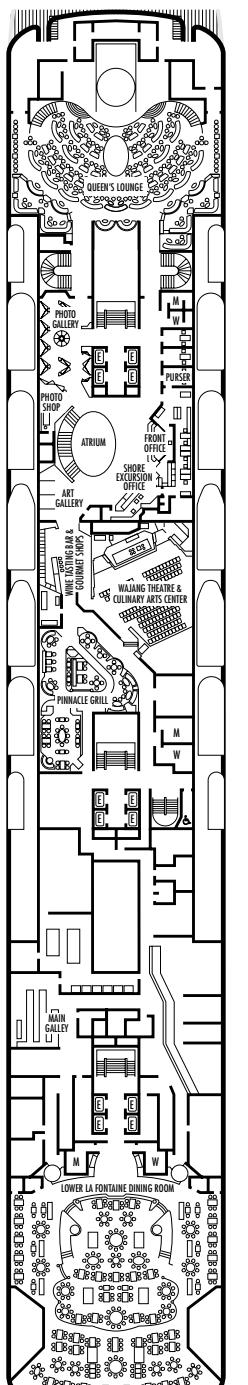

UPPER PROMENADE DECK

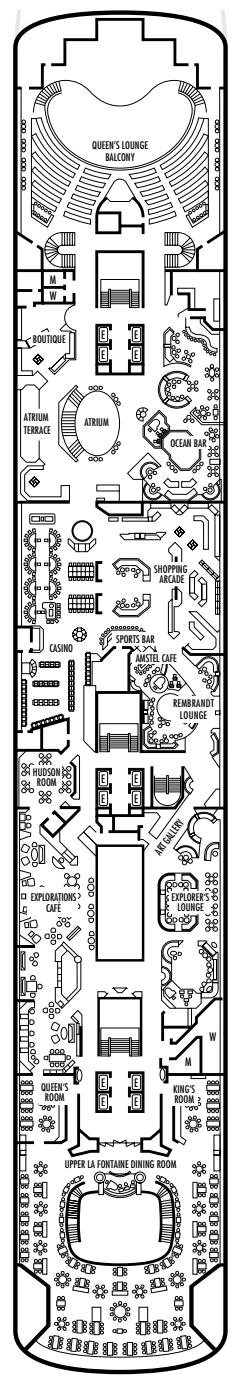

VERANDAH DECK
Staterooms 6100–6228
138 ft. from bow to
Staterooms 6100 & 6102.

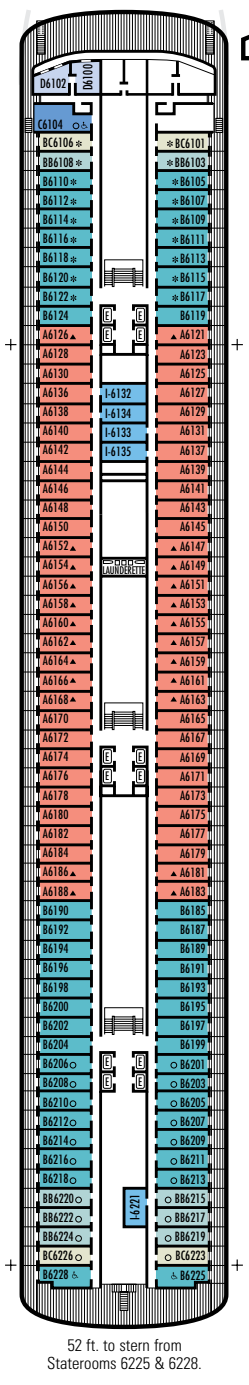

52 ft. to stern from
Staterooms 6225 & 6228.

NAVIGATION DECK
Staterooms 7001–7058
226 ft. from bow to
Staterooms 7001 & 7002.

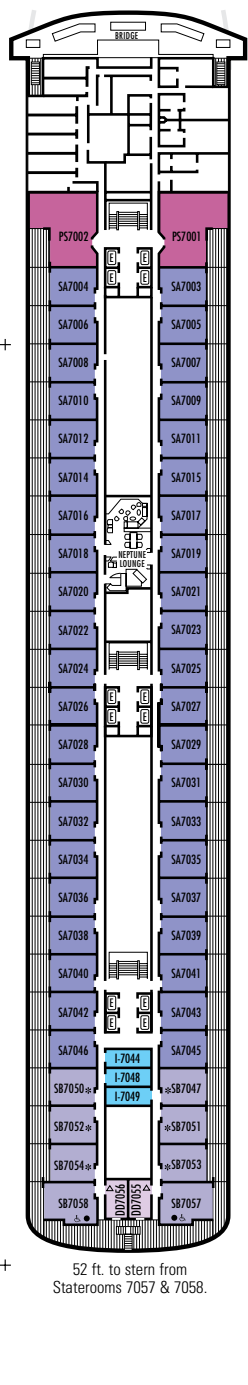

52 ft. to stern from
Staterooms 7057 & 7058.

LIDO DECK

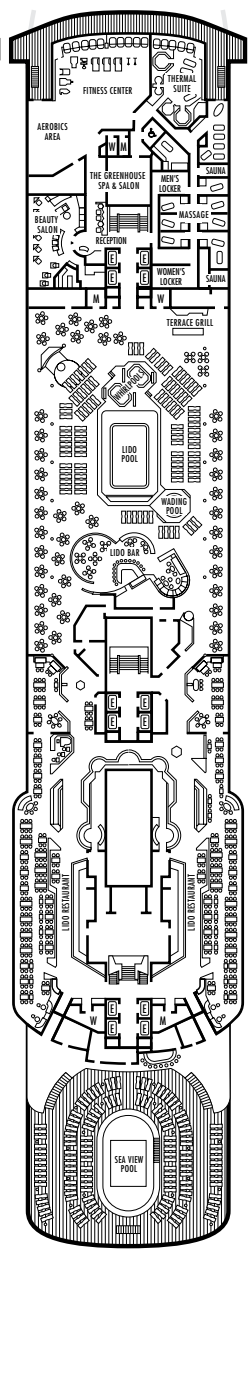

SPORTS DECK

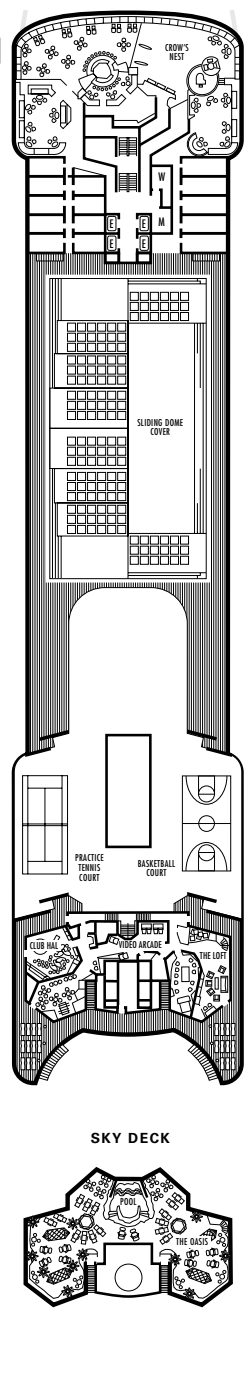

ms Amsterdam

DECK PLANS & STATEROOMS

The deck plans are color-coded by category of stateroom, and the category letter precedes the stateroom number in each room. All staterooms are equipped with DVD player, flat-panel television, telephone and multi-channel music.

Important Note: Not all staterooms within each category have the same furniture configuration and/or facilities. Appropriate symbols within the rooms on the deck plans describe differences from the stateroom descriptions below.

VERANDAH SUITES

PS
Penthouse Verandah Suites: Bedroom with 1 king-size bed, oversize whirlpool bath & shower, living room, dining room, dressing room, private verandah, pantry, 1 sofa bed for 2 persons, mini-bar, refrigerator, guest toilet, floor-to-ceiling windows.

SA SB
Deluxe Verandah Suites: 2 lower beds convertible to 1 king-size bed, whirlpool bath & shower, large sitting area, dressing room, private verandah, 1 sofa bed for 2 persons, mini-bar, refrigerator, floor-to-ceiling windows.

A B BB BC
Verandah Suites: 2 lower beds convertible to 1 queen-size bed, whirlpool bath & shower, sitting area, private verandah, mini-bar, refrigerator, floor-to-ceiling windows.

OCEAN-VIEW STATEROOMS

C D DA DD E
Large: 2 lower beds convertible to 1 queen-size bed, bathtub & shower. All DD-category staterooms have partial sea views.

FF
Large: 2 lower beds convertible to 1 queen-size bed, 1 sofa bed & pullman upper, bathtub & shower.

HH
Large: 2 lower beds convertible to 1 queen-size bed, bathtub & shower. All HH-category staterooms have fully obstructed views.

INSIDE STATEROOMS

I J K M MM
Large: 2 lower beds convertible to 1 queen-size bed, shower.

L
Standard: 2 lower beds convertible to 1 queen-size bed, 1 sofa bed & pullman upper, shower.

N NN
Standard: 2 lower beds convertible to 1 queen-size bed, 1 sofa bed & pullman upper, shower.

STATEROOM SYMBOL LEGEND

- * Shower only
- Bathtub & shower
- ▲ 2 lower beds or converts to 1 queen-size
- ▲ Triple (2 lower beds, 1 sofa bed)
- Quad (2 lower beds, 1 sofa bed, 1 upper)
- △ Partial sea view
- × Fully obstructed view
- + Connecting rooms
- ◇ These staterooms have portholes instead of windows
- ♿ Staterooms SB7057, SB7058 are wheelchair accessible, bathtub & shower. Staterooms B6225, B6228, C6104, D3431, DD3393, DD3394, FF1955, FF1964, G2500, G2702, H1804, H1805, H1806, H1807, HH3428, HH3433, K2554, K2555, L2700 are wheelchair accessible, shower only.

SHIP SPECIFICATIONS & FACILITIES

- 1,380 Guests
- 61,000 Gross Tons
- 780 Feet Long
- Automatic Stabilizers
- 10 Guest Decks
- 12 Guest Elevators
- 18 Public Rooms
- 3 Restaurants
- 2 Outdoor Swimming Pools (one with sliding glass roof)
- Spa & Salon
- Fitness Center
- Movie Theatre
- Duty-free Shops
- Internet Center
- Library
- Casino
- Suite Lounge
- Practice Tennis Court
- Basketball Court

