

CATEGORIES & DECKS

INSIDE

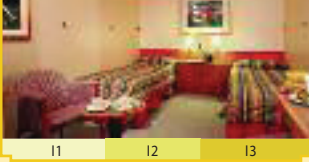

I1 I2 I3

DECKS 1, 4, 5, 6, 7, 8
Inside; 2 lower beds convert to queen

OCEANVIEW



E1† E2

DECKS 1, 4
Oceanview; 2 lower beds convert to queen

VERANDA

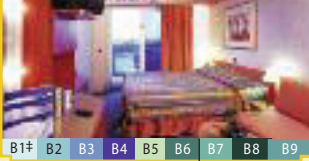

B1# B2 B3 B4 B5 B6 B7 B8 B9

DECKS 4, 5, 6, 7, 8
Oceanview with veranda
DECKS 4, 5, 6, 7, 8
Oceanview with large veranda
All categories 2 lower beds convert to queen

SUITE



S PS GS

DECKS 4, 5, 6, 7
Suites with veranda; 2 lower beds convert to queen, whirlpool bath, shower and sitting area

WELLNESS

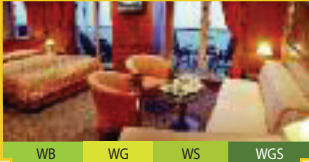

WB WG WS WGS

WELLNESS VERANDA STATEROOMS & SUITES
DECK 8

A relaxing retreat with accompanying exclusive spa amenities featuring complimentary treatments, personalized wellness consultation, fitness classes and wellness dining.

Built in 2000 for approx. 400 million Euros
Double Occupancy Capacity: 2,114
Crew and Staff: 920
Gross Tonnage: 86,000

Staterooms:
Inside: 212
Oceanview: 167
Verandas: 580
Suites: 8
Panorama Suites: 34
Grand Suites: 12
Wellness Staterooms: 44
% of Staterooms with Verandas: 64%

LEGEND

- No symbol indicates 2 lower beds. All staterooms with 2 lower beds convert to queen.
- 1 upper bed
- 2 upper beds
- Single sofa bed
- ‡ Category E1 staterooms are obstructed view; Category B1 are partially obstructed
- E Elevator
- H Accommodations for handicapped
- Connecting staterooms

Stateroom photos are not representative of all categories. Deck plans are subject to change.

Tennis Court, Jogging Track and Slide on La Voce Della Luna Deck (11) not shown.

For more detailed deck plans visit costacruz.com.

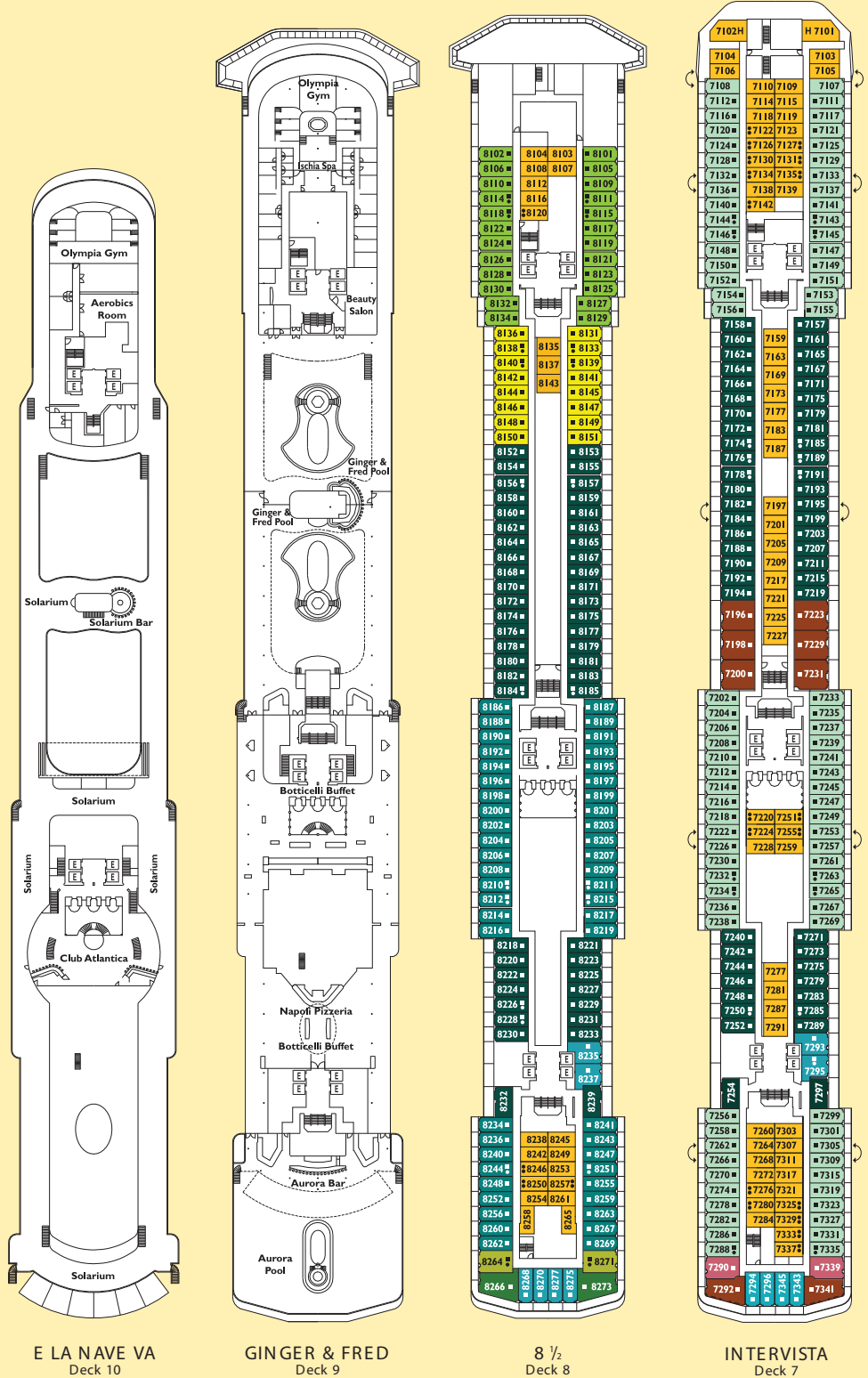

COSTA ATLANTICA

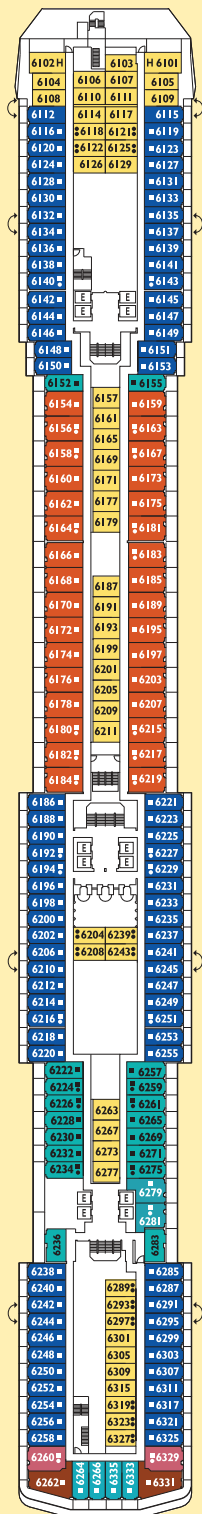

AMARCORD
Deck 6

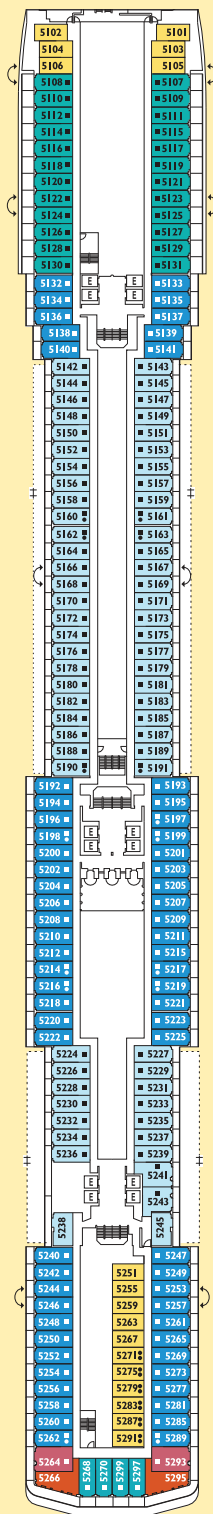

I CLOWNS
Deck 5

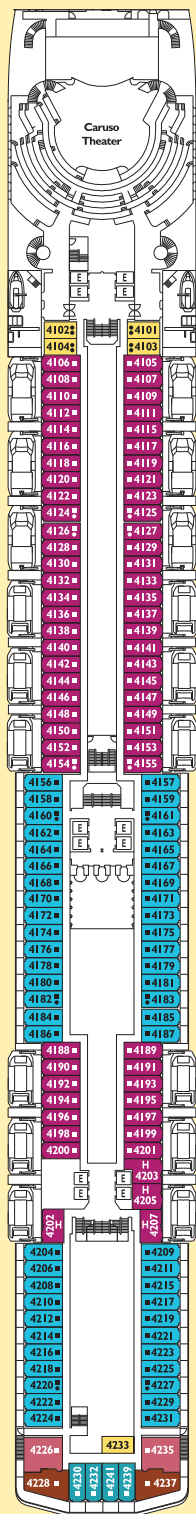

ROMA
Deck 4

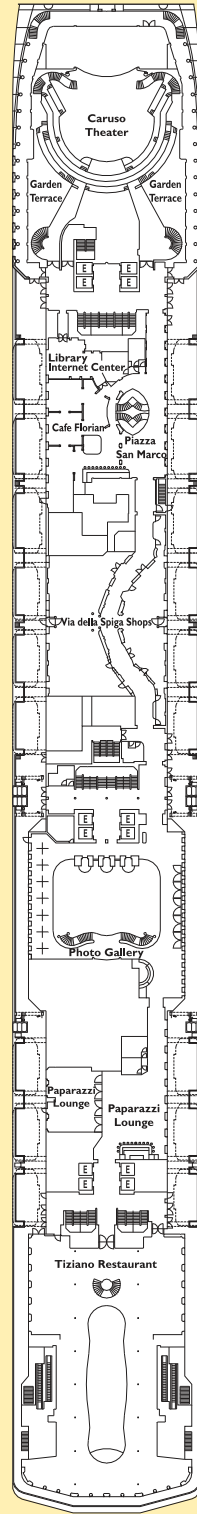

LA STRADA
Deck 3

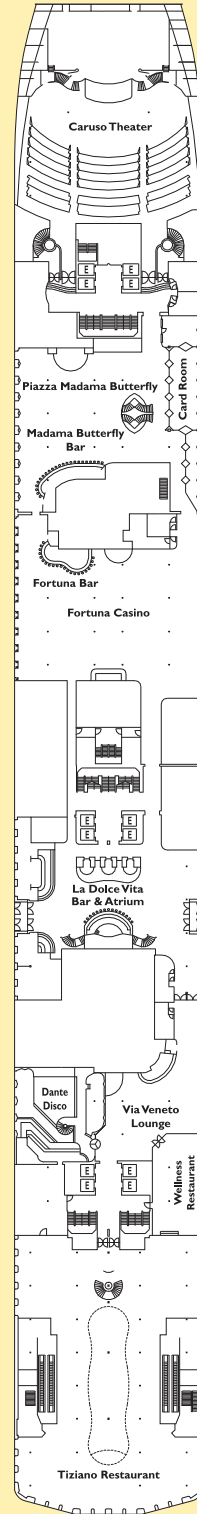

LA DOLCE VITA
Deck 2

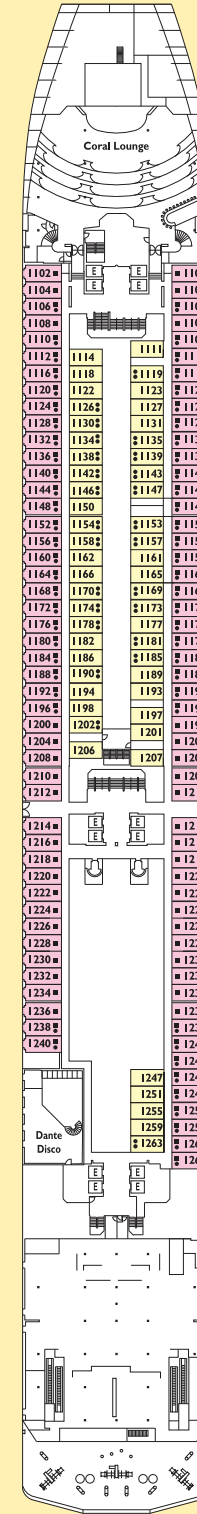

LUCI DEL VARIETA
Deck 1