

Love of Quilting



Have Fun with Kindred Spirits, Recharge Your Batteries, & Enjoy Balmy Quilting Weather

Our Speakers on the Love of Quilting cruise are:
Jodie Davis, Marianne Fons, and Jean Nolte

Two Project Choices

Pricing & Booking Information

(Full details:

http://www.InSightCruises.com/booking_d/qu01_booking.html)

Course Fees: \$895. Only passengers booked through InSight Cruises will be admitted. The fee includes all necessary quilting notions; three days of classes to create one of the kits from the two project options; all four lectures; three one-hour, open-bar cocktail parties; a complimentary spa treatment; and after-class access to a sewing room. Our organized events only take place when we're at sea, between 8:30am and 7:30pm.

Deposit: \$400 per person.

OPTION 1: Jodie's Sampler

Instructor: [Jodie Davis](#)

Learn and perfect your piecing and pressing skills while making Jodie Davis' sampler quilt. With simple brick walk rectangle blocks, friendship star blocks, pinwheel blocks, hourglass blocks, and nine patch blocks, this is a great opportunity to increase your know-how and cultivate new skills.



The fun begins on the first day of the class — we'll cut and organize our fabrics into bags and get started on the center of the quilt. The second and third days we'll work through our bags of quilt pieces to create blocks and grow our quilt tops, ending up with pieced borders. You may even finish the top! *Jodie's Sampler* is easy enough for a new quilter who has a few projects under her belt and useful for anyone looking to pick up quilting secrets and finesse. (Finished size is 96" x 108".)

Cabin Type:	Cruise Rate (per person)
Interiors	\$799 - \$899
Ocean Views	\$999 - \$1,099
Verandahs	\$1,199 - \$1,399
Suites	\$1,799 - \$2,599

The pricing above is subject to change.

Physically Challenged: The ship has a very limited number of specially equipped cabins for the Physically Challenged. Please let us know your specific needs.

Sharing: For those wishing to share a cabin with another passenger in our group in an inside, outside, or outside w/ verandah cabin only. The prices are the same as the per person double occupancy rates.

3rd Person Rate: \$350 (under 2 years old); \$450 (2 and older)

Single Occupancy: If you would like to be the sole occupant of a cabin, there is a single-occupancy upcharge: 50% for all non-verandah cabins; 100% for all verandah cabins.

Port Charges, Taxes, and Gratuities: Government taxes and cruiseline fees are approximately \$54, gratuities are \$11 per person per day, and there's an InSight Cruises service charge of \$50. Port charges are included in the cruise fare.

Full payment is due on September 1, 2010

(or, if you book after September 1, at the time of booking).

There is a \$25 charge for returned checks.

Air Add-ons: Airfare from most major cities is available through the cruise line. You can call our office for this pricing. (These rates include transfers to/from the dock/airport plus transfers to/from your hotel if we've booked the hotel as well.) In most cases, however, you will find better airfares on your own. Online travel sites such as Expedia.com, or Orbitz.com are excellent resources.

From nine patch to flying geese, learn to cut, piece, and press the basic building blocks of quilts.

Choose a kit from two color choices: batiks or 30's prints and rev up your quilt craft:

- Quick cutting and sewing
- Pressing savvy
- Half-square and quarter-square triangles
- Flying geese expertise
- Getting the knack of nine patch

OPTION 2: Christmas Joy

Instructor: Jean Nolte

Start a family tradition by making the *Christmas Joy* quilt to display during the holidays. Row by row, you'll add new techniques and polish up existing skills while making this row quilt designed by Marianne Fons and Liz Porter.

Variety is the spice of quilting life. Join Editor Jean Nolte in a techniques-oriented workshop designed to help you wield the tools of the trade more proficiently; challenge you to stretch your comfort zone; and get you to feel at ease with more complex but vital methods of translating your creative vision into your quilt.



(Finished size is 81" x 95".)

Relax and let Jean share her experience with you and come away with a sense of accomplishment. Through the *Christmas Joy* quilt, pick up time-honored techniques, plus tips and tricks on:

- The hows and whys of diagonal seams
- Squaring up blocks: doing it right the first time, step by step
- The ups and downs of setting blocks on point
- Easy foundation piecing: materials, permanent vs. temporary, templates and tips
- Making Flying Geese units
- Simple appliqué to add design elements where piecing won't work
- Making pieced letters
- Using strip sets for borders and binding, with tips to make it a breeze
- Making a label for your quilt: the how, what, why, and when

Four Lectures

NOTE: Holland America will not accept any booking unless a fully completed Reservation Form is accompanied with a per-person deposit:

http://www.InSightCruises.com/booking_d/qu01_booking.html. Have questions? Want to book voice-to-voice? Please give us a call: 650-787-5665



neil@InSightCruises.com
theresa@InSightCruises.com

InSight Cruises, Inc.
264 S. Meridith Avenue
Pasadena, CA 91106
650-787-5665
CST# 2065380-40

Why We Quilt

Speaker: [Marianne Fons](#)

In this entertaining and informative visual presentation, Marianne Fons examines the motivations of American quilters from 1776 to the present day. Her lecture is illustrated with scores of quilts from museums and institutions around the U.S., as well as quilts from Fons & Porter's *Love of Quilting*.

My Favorite "Quilty" Things

Speaker: **Marianne Fons**

In this informal session, Marianne Fons provides the inside story on the creation of the successful Fons & Porter collection of special, better tools for quilters. You'll learn what it takes to build a better mousetrap, find out which are her "faves" and enjoy mini-demos of several of the most popular items.

Top TV Tips

Speaker: Marianne Fons

"Love of Quilting" co-host Marianne Fons shares favorite viewer tips from over a decade at the Tip Table on Fons & Porter's popular show "Love of Quilting." Learn how TV viewers handle binding control, tool storage, and stash management. Bring your own favorite tip to share!

Sew Much Fun with Marianne & Mary

Speaker: **Marianne Fons**

For this informal session, seasoned quilter Marianne Fons and her daughter, budding quilter Mary Fons, share the perspectives of two distinctly different generations of quilters. TV viewers have enjoyed the mother-daughter dynamic of Marianne and Mary on their public television episodes. Here's an opportunity to share the fun in person.

DAY	PORT	ARRIVE	DEPART	CONFERENCE SESSIONS
FRIDAY, DEC. 3	FT. LAUDERDALE	—	5pm	6:30pm, Bon Voyage COCKTAIL PARTY*
SATURDAY, DEC. 4	AT SEA	—	—	10am – NOON & 1:30pm – 4:30pm; 5pm – 6:30pm
SUNDAY, DEC. 5	AT SEA	—	—	10am – NOON & 1:30pm – 4:30pm; 5pm – 6:30pm
MONDAY, DEC. 6	WILLEMSTAD, CURAÇAO	8am	11pm	6:30pm – 7:30pm
TUESDAY, DEC. 7	ORANJESTAD, ARUBA	7am	2pm	2pm – 6pm; 6:30pm, COCKTAIL PARTY*
WEDNESDAY, DEC. 8	AT SEA	—	—	10am – NOON & 1:30pm – 4:30pm; 5pm – 6:30pm
THURSDAY, DEC. 9	HALF MOON CAY, BAHAMAS	8am	4pm	5pm – 6pm; 6:30pm, COCKTAIL PARTY*
FRIDAY, DEC. 10	FT. LAUDERDALE, FLORIDA	7am	—	<i>Do not fly out prior to 11:30am</i>

***Open bar plus hot & cold hors d'oeuvres served. All guests invited.**

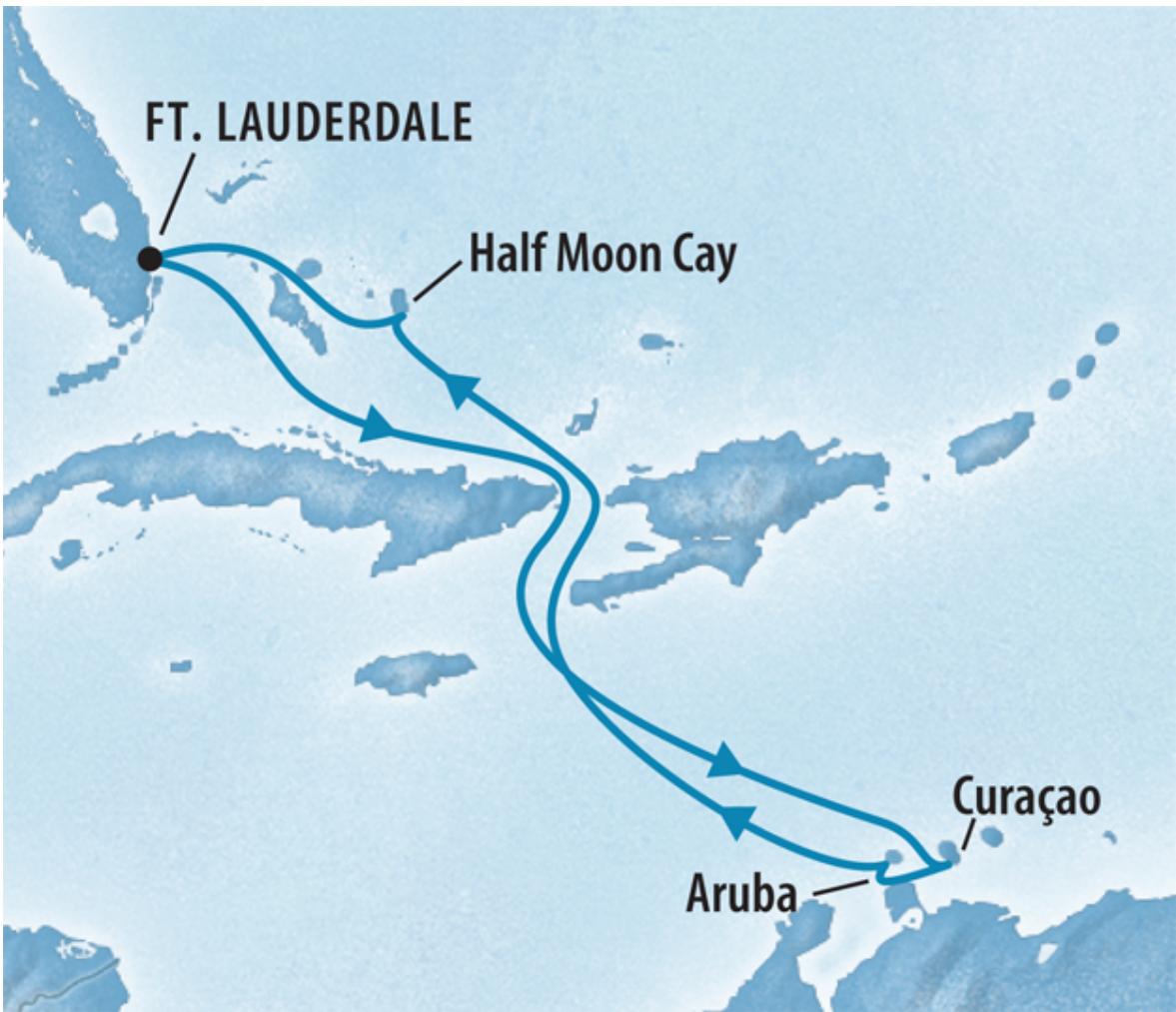

Better Interior: \$799 – \$899

Oceanview: \$999 – \$1,099

Verandah: \$1,199 – \$1,399

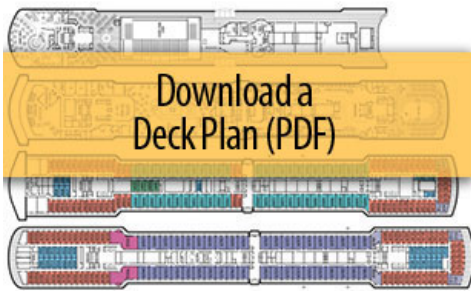

Deck Plan of Our Ship (pdf)



Superior Suite: \$1,799



Full Suite: \$2,599

MAIN DECK
Staterooms 1001–1127
252 ft. from bow to
Staterooms 1001 & 1002.

LOWER PROMENADE DECK

PROMENADE DECK

UPPER PROMENADE DECK
Staterooms 4001–4185
102 ft. from bow to
Staterooms 4001 & 4002.

VERANDAH DECK
Staterooms 5001–5191
102 ft. from bow to
Staterooms 5001 & 5002.

UPPER VERANDAH DECK
Staterooms 6001–6177
112 ft. from bow to
Staterooms 6003 & 6004.

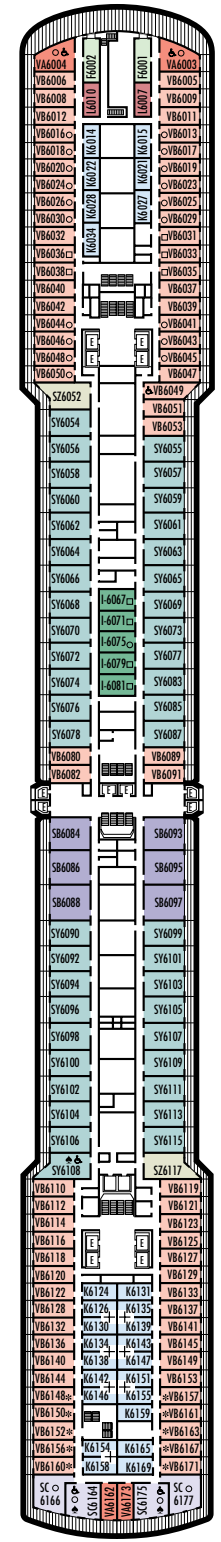
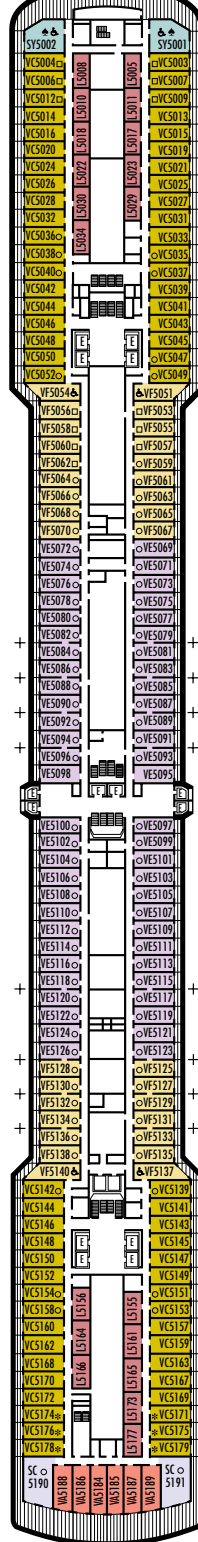
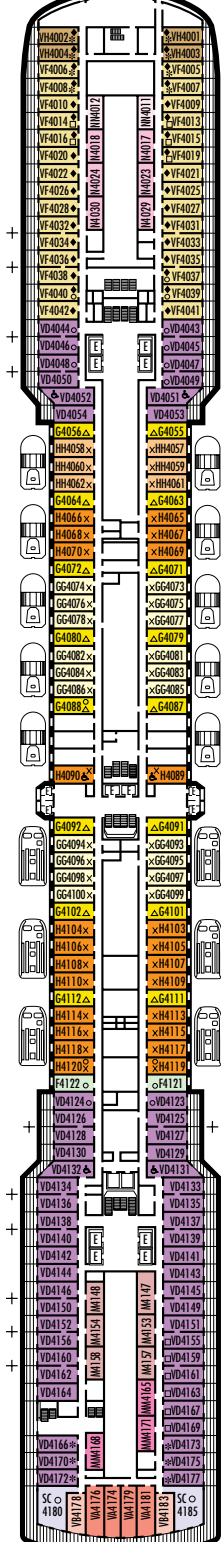
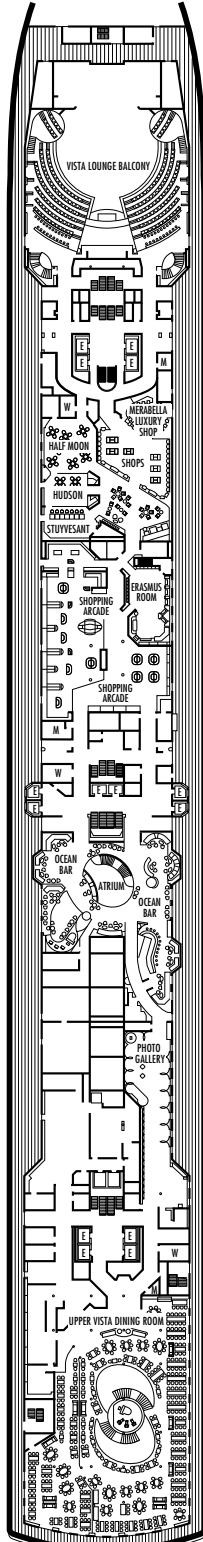
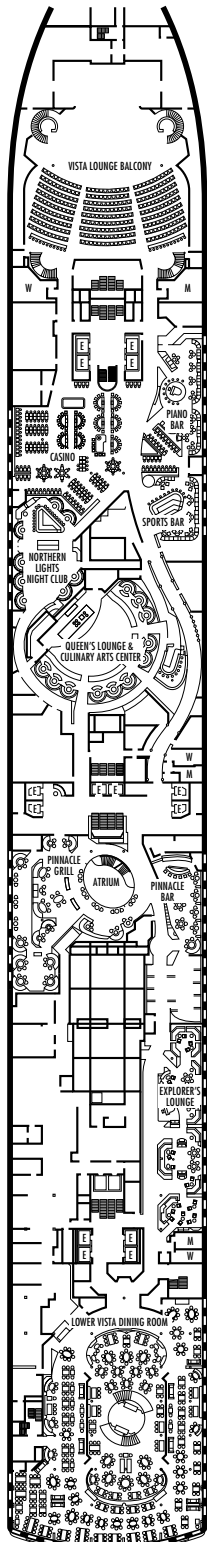
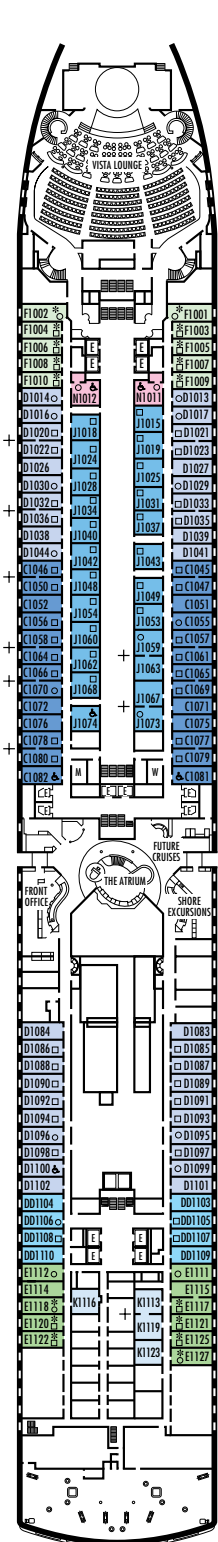

102 ft. to stern from
Staterooms 1123 & 1127.

9 ft. to stern from
Staterooms 4174 & 4179.

23 ft. to stern from
Staterooms 5184 & 5185.

21 ft. to stern from
Staterooms 6162 & 6173.

STATEROOM SYMBOL LEGEND

- Triple (2 lower beds, 1 sofa bed)
- Quad (2 lower beds, 1 sofa bed, 1 upper)
- △ Partial sea view
- × Fully obstructed view
- + Connecting rooms
- * Shower only
- ♠ Single sink vanity

- ◆ Staterooms have solid steel verandah railings instead of clear-view Plexiglas® railings
- ♿ Staterooms SS808, SC6175, SC6164, SY5002, SY5001 are wheelchair accessible, bathtub and roll-in shower. Staterooms I-8037, VA8032, VA8031, SY6108, VB6049, VA6004, VA6003, VF5140, VF5137, VF5054, VF5051, VD4132, VD4131, H4090, H4089, VD4052, VD4051, D1100, C1082, C1081, J1074, N1012 & N1011 are wheelchair accessible, roll-in shower only.

SHIP SPECIFICATIONS & FACILITIES

- 1,916 Guests
- 82,348 Gross Tons
- 936 Feet Long
- Automatic Stabilizers
- 11 Guest Decks
- 14 Guest Elevators
- 4 Outside Elevators
- 4 Restaurants
- 2 Show Lounges
- Outdoor Swimming Pools (one with sliding glass roof)
- Spa & Salon
- Fitness Center
- Suite Lounge
- Duty-free Shops
- Internet Center
- Library
- Basketball Court
- Volleyball Court

ROTTERDAM DECK
Staterooms 7001–7151
121 ft. from bow to
Staterooms 7001 & 7002.

NAVIGATION DECK
Staterooms 8001–8147
186 ft. from bow to
Staterooms 8001 & 8002.

LIDO DECK

OBSERVATION DECK

SPORTS DECK

ms Westerdam

DECK PLANS & STATEROOMS

The deck plans are color-coded by category of stateroom, and the category letter precedes the stateroom number in each room. All staterooms are equipped with flat-panel television, mini-bar, DVD player, mini-safe, data port, telephone and multi-channel music.

Important Note: Not all staterooms within each category have the same furniture configuration and/or facilities. Appropriate symbols within the rooms on the deck plans describe differences from the stateroom descriptions below.

VERANDAH SUITES

PS

Penthouse Verandah Suites: Bedroom with 1 king-size bed, oversized whirlpool bath & shower & additional shower stall, living room & dining room, dressing room, private verandah with whirlpool, pantry, 1 sofa bed for 2 persons, microwave, refrigerator, guest toilet, private stereo system, floor-to-ceiling windows.

SA SB SC

Deluxe Verandah Suites: 2 lower beds convertible to 1 king-size bed, bathroom with dual sink vanity, full-size whirlpool bath & shower & additional shower stall, large sitting area, dressing room, private verandah, 1 sofa bed for 2 persons, floor-to-ceiling windows.

SS SY SZ

Superior Verandah Suites: 2 lower beds convertible to 1 queen-size bed, bathroom with dual sink vanity, full-size whirlpool bath & shower & additional shower stall, large sitting area, private verandah, 1 sofa bed for 1 person, floor-to-ceiling windows.

VERANDAH STATEROOMS

VA VB VC VD VE

VF VH

Deluxe Verandah Ocean-view: 2 lower beds convertible to 1 queen-size bed, bathtub & shower, sitting area, private verandah, floor-to-ceiling windows.

OCEAN-VIEW STATEROOMS

C D DD E F

Large: 2 lower beds convertible to 1 queen-size bed, bathtub & shower.

G GG

Large: 2 lower beds convertible to 1 queen-size bed, bathtub & shower. All G-category staterooms have partial sea views. All GG-category staterooms have fully obstructed views.

H HH

Large: 2 lower beds convertible to 1 queen-size bed, bathtub & shower. All H- & HH-category staterooms have fully obstructed views.

INTERIOR STATEROOMS

I

Large: 2 lower beds convertible to 1 queen-size bed, shower.

J K

Large or Standard: 2 lower beds convertible to 1 queen-size bed, shower.

L M MM N NN

Standard: 2 lower beds convertible to 1 queen-size bed, shower.

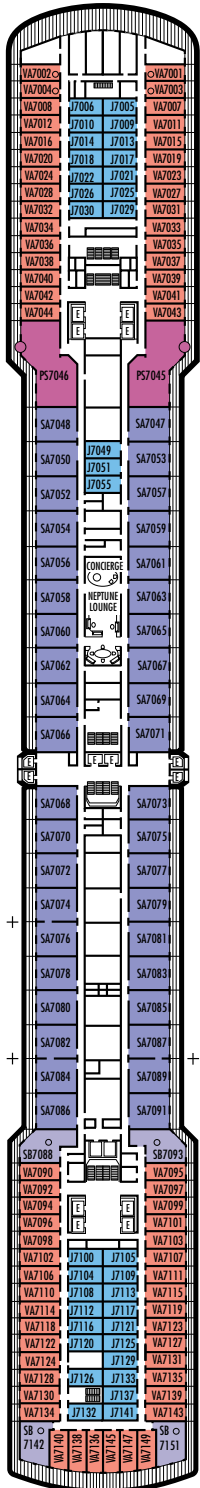

27 ft. to stern from
Staterooms 7136 & 7145.

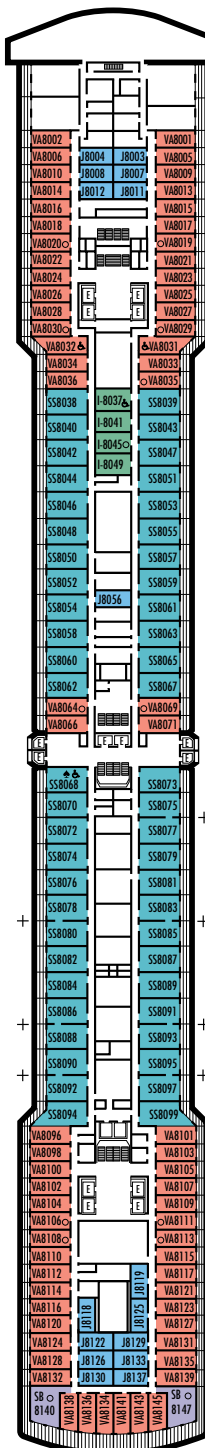

34 ft. to stern from
Staterooms 8134 & 8141.

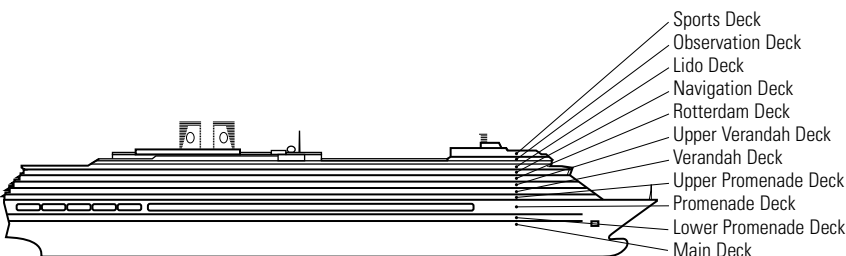
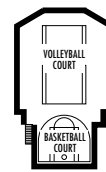
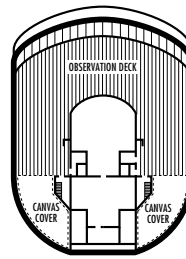
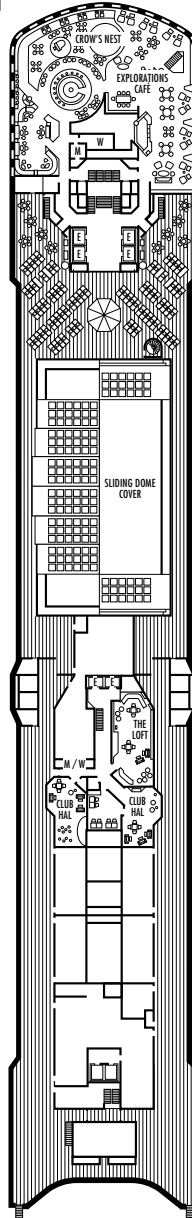
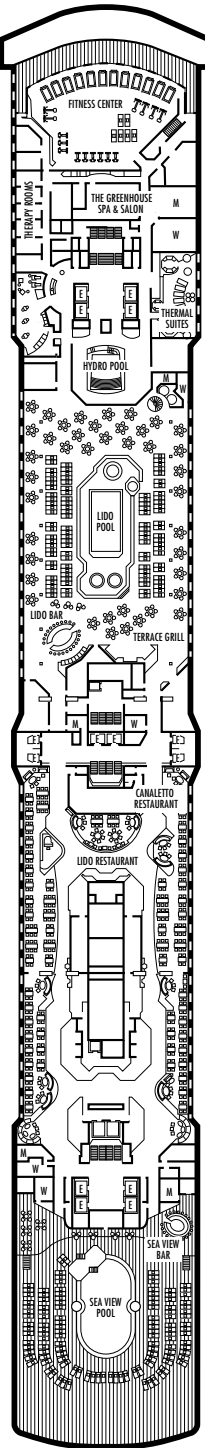

- Sports Deck
- Observation Deck
- Lido Deck
- Navigation Deck
- Rotterdam Deck
- Upper Verandah Deck
- Verandah Deck
- Upper Promenade Deck
- Promenade Deck
- Lower Promenade Deck
- Main Deck